

# Evolution Fury5 table saw

Mark Baker looks at the brand new Fury5 table saw which is capable of delivering the perfect cut

## CONTACT DETAILS:

**Price:** £169.98 (inc VAT at 20%)

**Contact:** Evolution

**Tel:** 0114 251 1022

**Website:** [www.evolutionpowertools.com](http://www.evolutionpowertools.com)

PHOTOGRAPHS BY GMC/ANTHONY BAILEY



Preparation is important, so ensure to take your time to set up the guide fence/rail properly

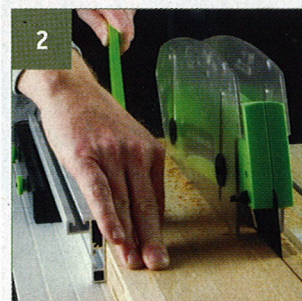

It is important to keep yourself safe so make sure you wear eye and ear protection



Check and adjust the table extensions until they are all aligned and level



You should always clamp down the piece you are cutting – this will avoid slippage



Even with easy blade adjustment always, once adjusted, make a cut on scrap timber to check it first

**T**able saws are a great addition to any workshop and these can be static or portable units. The latter is ideal if you have to move equipment around on various jobs, or if you have a lack of space. Evolution produce chop and circular saws and have now introduced this table saw version.

The blades Evolution produce are designed to cut wood, acrylics and metal. So being multipurpose, the blade is even more versatile than a conventional wood blade. This is one machine that produces many different material cutting options.

## TIP 1

Any saw is only as good as the initial setting up so it is worth taking your time to set up the guide fence/rail properly. Check it over with a square to make sure you have it properly aligned – this is vital to ensure cutting accuracy.

## TIP 2

When cutting anything it is important to keep yourself safe by making sure you wear eye and ear protection, and use the push stick to keep your hands away from the blade area.

## TIP 3

Check and adjust the table extensions until they

are all aligned and level with one another. You can use a level for this as it gives a good, straight edge for you to check with. It is also worth cross checking this with the blade so that it is at 90° to the bed, when the table saw is in standard cutting mode.

## TIP 4

When any form of cutting is made that requires the use of the adjustable angle guide then you should clamp the piece down to prevent slippage. I clamped 4mm steel angle iron then guided it through the cut with my hands, making sure it was away from the blade area.

It is important that you do not exert too much pressure during the cut – a smooth guiding action produces a controlled, accurate cut that will then require minimal finishing.

## TIP 5

When adjusting any blade angle you should double check the setting and make a test cut first to check to see if it is what you require.

