

evolution®

evolutionpowertools.com

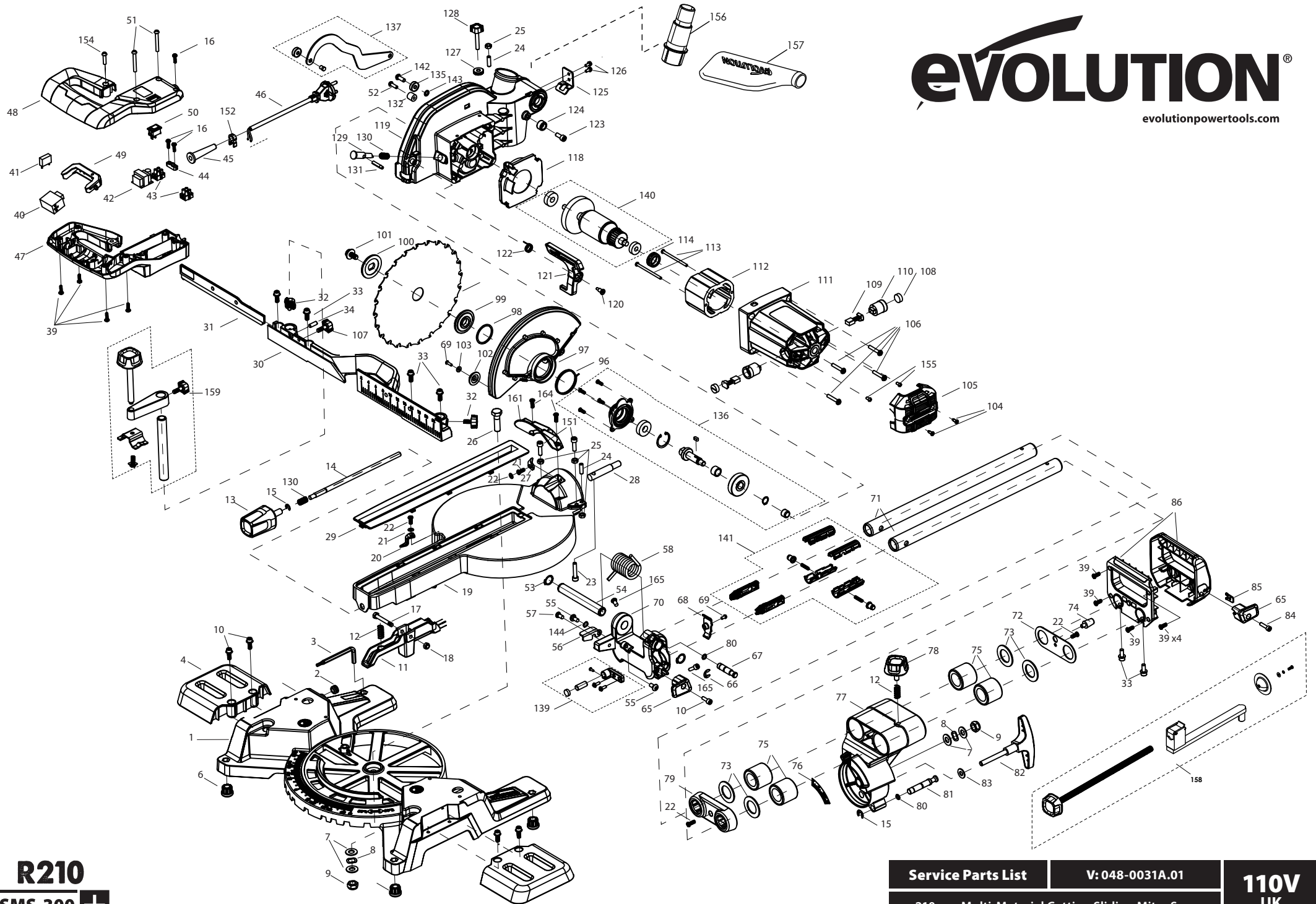

R210

SMS-300 +

Service Parts List

V: 048-0031A.01

**110V
UK**

210mm Multi-Material Cutting Sliding Mitre Saw

No.	Description	Part Code	Qty
1	Base (SMS-300) (BLK)	048-0300	1
2	Grommet 10mm	048-0101	1
3	Dual Hex Key	048-0102	1
4	Table Extension (SMS-300)	048-0301	2
6	Foot	048-0105	4
7	Flat Washer 10mm	F-W-M10-ST-BO	4
8	Wave Washer 12mm	048-0113	2
9	Nylock Nut M10	F-NNIF-M10-ST-BO	2
10	Cap Screw M5x20	F-SHCS-M5-20-ST-BO	5
11	Table Positioning Handle (SMS-300)	048-0302	1
12	Spring	048-0108	1
13	Table locking knob (R210)	048-0109	1
14	Push Rod (SMS-300)	048-0303	1
15	External E-clip 6mm	048-0112	2
16	Tapping Screw 4X16	F-TFPX-4-16-ST-BO	3
17	Screw M6x43	F-HB-M6-43-8-ST-BO	1
18	Nylock Nut M6	F-NNIF-M6-ST-BO	1
19	Table (SMS-300)	048-0304	1
20	Table Indicator (R210)	048-0115	1
21	Flat Washer 5mm	F-W-M5-ST-BO	2
22	Cross Head Screw M5X12	F-SPHPZ-M5-12-ST-BO	4
23	Cap Screw M6x30	F-SHCS-M6-30-ST-BO	3
24	Grub Screw M6X20	F-SSCCP-M6-20-ST-BO	2
25	Hex Nut M6	F-NSF-M6-ST-BO	4
26	Hex Head Bolt M10x45	F-HB-M10-45-25-ST-BO	1
27	Neck indicator (R210)	048-0117	1
28	Connecting Bolt	048-0119	1
29	Channel Guide (SMS-300)	048-0305	1
30	Fence (SMS-300)	048-0306	1
31	Movable fence (SMS-300)	048-0307	1
32	Wing screw (R210) 13mm	048-0124	2
33	Fence Bolts (custom hex bolts M6)	048-0248	5
34	Grub Screw M6X16	F-SSCCP-M6-16-ST-BO	1
39	Tapping Screw 4X14	F-TFPX-4-14-ST-BO	9
40	On/Off Switch	048-0131	1
41	Capacitor (110v) UK	048-0133	1
42	Laser Transformer (110V) UK	048-0137	1
43	Connection Block	048-0140	2
44	Cable Clamp	048-0141	1
45	Cable Sheath	048-0142	1
46	Power Cable 110V UK (3m Rubber)	048-0271	1
47	Lower Handle	048-0143	1
48	Upper Handle	048-0144	1
49	Trigger (R210)	048-0145	1
50	Laser Switch	048-0147	1
51	Cross Head Screw M5X40	F-SPHPZ-M5-40-ST-BO	2
52	Cross Head Screw M5X16	F-SPHPZ-M5-16-ST-BO	2
53	External Circlip 16mm	F-CCEXT-16-100-ST-PO	2
54	head Pivot Axle	048-0148	1
55	Cross Head Shoulder Screw M6x9	048-0149	2
56	Trench stop	048-0150	1
57	Cross Head Shoulder Screw M6x9	048-0151	1
58	Torsion Spring	048-0152	1
65	Cable tidy (R210)	048-0154	2
66	External E-clip 8mm	048-0156	1
67	Lockdown Pin Knob	048-0157	1
68	Laser Wire Cover	048-0158	1
69	Cross Head Screw M4x8	F-SPHPZ-M4-8-ST-BO	2
70	Head Pivot	048-0159	1
71	Rail (SMS-300)	048-0308	2
72	Bevel bracket Cover	048-0161	1
73	Shaft Seal Ring	030-0192	4
74	Rubber Stop	030-0152	2

No.	Description	Part Code	Qty
75	Linear Ball Bearing	048-0162	4
76	Bevel Label	048-0163	1
77	Bevel bracket	048-0164	1
78	Sliding Lock Screw (R210)	048-0165	1
79	Rail Spacer Cover	048-0311	1
80	O-Ring	048-0167	2
81	33.9 Pin	048-0168	1
82	Bevel Lock lever (R210)	048-0169	1
83	Flat Washer 8mm	048-0171	1
84	Cap Tapping Screw 5x20	F-TFPX-5-20-ST-BO	1
85	Cable Strain	048-0172	1
86	Rear Handle (Plus Unit)	048-0265	1
96	Blade Guard Torsion Spring	048-0183	1
97	Blade Guard (BLK)	048-0266	1
98	Blade guard Retaining ring	048-0185	1
99	Inner flange	048-0186	1
100	Outer flange	048-0187	1
101	Arbour Bolt M8x16	048-0188	1
102	Guard Roller	048-0189	1
103	Washer	F-W-M4-ST-BO	1
104	Tapping Screw 4X10	F-TFPX-4-10-ST-BO	2
105	Motor End Cap (R210)	048-0192	1
106	Cross Head Screw M5X30	F-SPHPZ-M5-30-ST-BO	4
107	Wing screw (R210) 18mm	048-0315	1
108	Brush Holder Cap	048-0194	2
109	Carbon Brush 110V (Pair)	048-0249	2
110	Brush Holder	048-0196	2
111	Motor Housing	048-0197	1
112	Field Coil 110V UK	048-0199	1
113	Tapping Screw M4x68	F-TFPX-M4-65-ST-BO	2
114	Bearing Cap	048-0202	1
118	Air Baffle	048-0207	1
119	Head	048-0208	1
120	Cross Head Shoulder Screw M4X6.7	048-0209	1
121	Guard lock lever (R210)	048-0210	1
122	Torsion Spring	048-0212	1
123	Cap Screw M6x16	F-SHCS-M6-16-ST-BO	1
124	Head Stop	048-0213	1
125	Finger Guard	048-0214	1
126	Cross Head Screw / Washer M4X10	048-0190	2
127	Trench Cut Adjustment	048-0215	1
128	Trench cut Knob (R210)	048-0216	1
129	Spindle lock	048-0218	1
130	Compression Spring	048-0219	2
131	Roll Pin 5mm	048-0220	1
132	Guard Stop	048-0223	1
135	Bearing 6x17x6	F-B-606-2Z	1
136	Gearbox Assembly	048-0229	1
137	Linkage Assembly	048-0230	1
139	Laser Assembly	048-0233	1
140	Armature Assembly 110V UK	048-0235	1
141	Slide Shaft Locking unit	048-0238	1
142	Cross Head Screw M6X16	F-SPHPZ-M6-16-ST-BO	1
143	Flat Washer 4mm	F-W-M4-ST-BO	1
144	Wave Washer 7mm	048-0239	1
151	Cap screw M6x20	F-SHCS-M6-20-ST-BO	2
152	Cord Clip 110V & 120V	048-0246	1
153	Label Set 110V UK	S300 label set	1
154	Cross Head Screw M5X20	F-SPHPZ-M5-20-ST-BO	1
155	Cross Head Screw M4x8	F-SPHPZ-M4-10-ST-BO	2
156	Dust Port Adaptor	027-0220	1
157	Dust Bag	048-0259	1
158	Front Clamp Assembly (Orange) 300mm	048-0320	1

No.	Description	Part Code	Qty
159	"Top Clamp Assembly SMS-300 (Plus Version)"	048-0330	1
161	Chip Guard (SMS-300)	048-0309	1
164	Cross Head Screw M5x14	F-SPHPZ-M5-14-ST-BO	2
165	Cap Screw M5x10	F-SHCS-M5-10-ST-BO	2



Service Parts List

V: 048-0031A.01

210mm Multi-Material Cutting Sliding Mitre Saw

110V
UK